

# Infa Warmer

Radiant Warmer



# To Save a Tiny Baby Life

## From Delivery Room to NICU

Meets wide needs with substantial functions and features.  
Through add-on unit, two kinds of resuscitation unit are available depending on user's demand.



# Infa Warmer *i*



Ease of Use



Temperature Control



Safety Function



Resuscitation Function



Ease of Use

Surgical operations can be performed safely in the NICU.



\*Drawer is optional



**T**ouch panel type display with excellent operability and functionality.

- The screen can be switched smoothly by intuitive operation.
- Visibility of weight measurement and alarm indication has improved.
- The pre-heat function can keep the mattress warm before use.



**X**-ray cassette tray accessible from 3 directions.

- X-ray cassette can be taken in and out from 3 directions, which does not interfere with the arrangement of peripheral devices.



Temperature Control

The infant's skin temperature can be prevented from falling.



**C**onvenient preheating function to warm the mattress sufficiently in an emergency.

- Postnatal care can be given on pre-heated warm mattress.

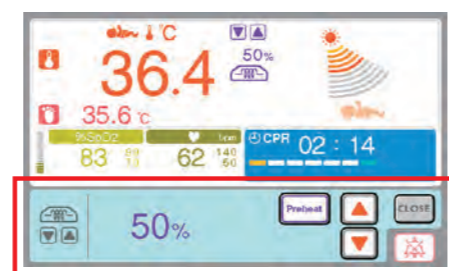

**F**ar infrared heater warms the mattress surface uniformly.

- The heater reflector improves the warming performance which leads to stable body temperature control.



**T**he canopy can be tilted independently.

- The examination light always illuminates the treatment space according to the inclination of canopy, temperature control.

Safety Function

Long-term management with less stress to the infant.



**D**etachable baby guard enables easy complete cleaning.

- The baby guard taking measures against blood invasion can be easily detached without tools and it reduces troubles of cleaning and maintenance.

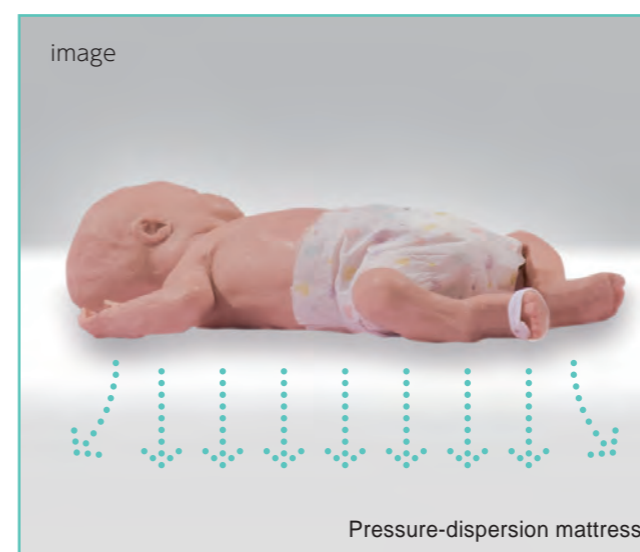

**P**ressure-dispersion mattress to provide stable and comfortable resting and sleeping surface.

- The pressure-dispersion mattress reduces the infant's stress by minimizing bedsores.



**B**aby Guard

- Thanks to rotary damper, the baby guard can be opened very silently without touching.

Resuscitation  
Function

Support smooth neonatal resuscitation



**S**upports safe artificial ventilation.  
(Blender Unit 105) <Add-on unit>

- Built-in oxygen blender and manometer supports manual ventilation, such as during replacement of breathing circuit.



**S**imple operation supports resuscitation.  
(Resuscitation Unit 104) <Add-on unit>

- By placing a face mask on the newborn, the user has the ability to control the inspiratory time by placing a finger on T Flow Valve.



Simple operation with a thumb

**T**he pulse oximeter is available as user's demand. <Add-on unit>

- The pulse oximeter makes administration of oxygen easy and safe.

**C**PR Timer

- Inform the timing to assess the health condition of newborn every 30 seconds.



**U**seful weight measurement with display operation. <Add-on unit>

- The infant's weight can be simply measured by laying the infant on mattress following to the guide on the display, which reduces infant's stress caused by handling.



Options



atom's code 61580  
**Power Pack i AC120V**  
atom's code 61581  
**Power Pack i AC230V**



atom's code 60988  
**Drawer w/mounting bracket**



atom's code 61627  
**Open Rack**



atom's code 23629  
**Gastroschisis support arm w/Bracket**



atom's code 23623  
**Baby Guard w/Inlet Packing**



atom's code 23628  
**Handle**  
(Mattress Platform Mounting Type)



atom's code 61617  
**Tray Set for F-Rail**  
atom's code 61618  
**Tray Set (S) for F-Rail**



atom's code 60216  
**Infa Lite AC100-240V**



atom's code 61642  
**Drainage Hanger (2 pcs/pkg)**



atom's code 60895  
**Cylinder Rack for F-Rail (1 pce)**



atom's code 23624  
**Inner Panel 3 pcs/set**



atom's code 60899  
**Handle for F-Rail (2 pcs/set)**



atom's code 60894  
**Basket w/arm for F-Rail**



atom's code 23719  
**Multi Holder (Baby guard mounting type)**



atom's code 61071  
**Cord Holder for F-Rail (5 pcs/pkg)**



atom's code 60349  
**Monitor Table for F-Rail**



atom's code 60350  
**Monitor Table**  
for Philips monitor for F-Rail

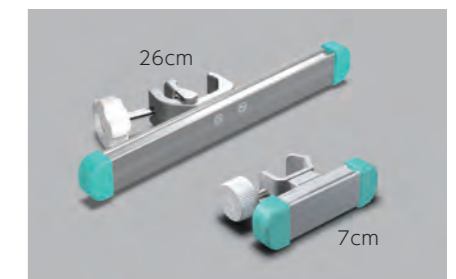

atom's code 60306  
**MF-Rail, 7cm Pole mounting type**  
atom's code 60367  
**MF-Rail, 26cm Pole mounting type**



atom's code 61616  
**MF-Rail for F-Rail (Left & Right)**



atom's code 23627  
**Tube Holder**  
(Mattress Platform Mounting Type)  
atom's code 60871  
**Tube Holder**  
(Baby guard Mounting Type)



atom's code 60893  
**I.V Pole for F-Rail**

Product Lineup

Infa Warmer *i*

Atom Infant Warmer 103

Main Unit

| Atom's code | Power requirements |
|-------------|--------------------|
| 61633       | AC120V ± 10%       |
| 61634       | AC230V ± 10%       |

Add-on Unit

| Atom's code | Description                     |
|-------------|---------------------------------|
| 61663       | SpO <sub>2</sub> Unit (Masimo)  |
| 61664       | SpO <sub>2</sub> Unit (Nellcor) |
| 61650       | Resuscitation Unit P type*1     |
| 61651       | Resuscitation Unit E type*2     |
| 61652       | Blender Unit P type*3           |
| 61653       | Blender Unit E type*4           |
| 23631       | Weight Monitor Unit             |

Dimensional drawing  
Unit:mm

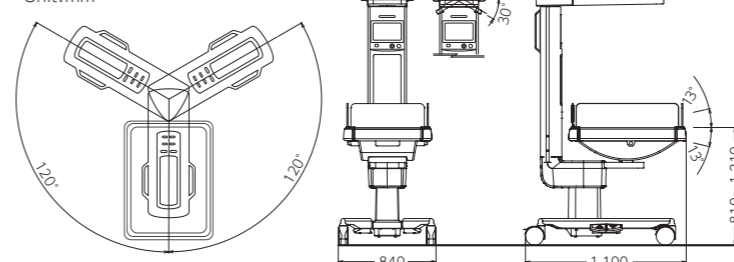

<Note>

- \*1:T-Piece Resuscitation Unit with Blender and Suction Unit (connect to central piping system)
- \*2:T-Piece Resuscitation Unit with Blender and Suction Unit of ejector type to make suction operation possible where no suction piping is available
- \*3:O<sub>2</sub> Blender Unit and Suction Unit (connect to central piping system)
- \*4:O<sub>2</sub> Blender Unit and Suction Unit of ejector type to make suction operation possible where no suction piping is available

## Specifications

|                           |   |                             |  |
|---------------------------|---|-----------------------------|--|
| Power requirements        | Customer specified  | Heater output setting range | 0~100% (in 5% increments)  |
| Power consumption         | 700VA   | Heater output indication    | In 10 levels   |
| Type/Degree of protection | Class I/Type BF applied part  | Skin temp. setting range    | 34.0~38.0°C / 93.2~100.4°F (in 0.1°C/°F increments)                                    |
| Display                   | Type : Liquid crystal (TFT-LCD)<br>Dot formation : 800×480dots<br>Number of colors : 256colors  | Skin temp. display range    | 30.0~42.0°C / 86.0~107.6°F (in 0.1°C/°F increments)                                    |
| Heater capacity           | 500W  | Skin temp. display accuracy | ±0.3°C / ±0.5°F  |
| Dimensions                | Main body : 840(W)x1100(D)x1790~2190(H) mm<br>Mattress : 500(W)x700(D)x25(H) mm   | Timer                       | 0~60 minutes 00 second (in one second increments)<br>Apgar mode / CPR mode selectable  |
| Mattress surface          | 810~1210 mm   | Mattress platform tilting   | Longitudinal tilt of ±13°(freely adjustable)   |
| Weight                    | Approx. 105Kg   | Canopy mobility range       | Horizontal rotation : 240°(120°both sides)<br>Radiation angle : ±30°                   |
| Accessories               | Skin temp. probe ..... 1<br>Mattress sheet ..... 1<br>Dust cover ..... 1<br>Cover baby ..... 3<br>Pressure dispersion mattress ..... 1<br>Cord holder ..... 2<br>Power cord ..... 1<br>Operation Manual ..... 1 | Lighting                    | LED lighting, intensity adjustable, 0~1200Lx   |
|                           |   | Preheat                     | Available  |
|                           |   | Alarms                      | Set temp., Baby check, Power failure, System failure,<br>Skin temp. probe, Canopy tilt |

## Specifications (Add-on Unit)

### SpO<sub>2</sub> Unit [Masimo/Nellcor]

|                            |  |
|----------------------------|--|
| SpO <sub>2</sub>           | Display range:1~100% Accuracy (in 70-100%)±3digits<br>Alarm function setting range:Upper limit 50~99%, OFF Lower limit 45~95%, OFF               |
| Pulse rate                 | Display range:25~240bpm Accuracy (in 25-240bpm)±3digits<br>Alarm function setting range:Upper limit 80~240bpm, OFF Lower limit 35~180bpm, OFF    |
| Mode (Masimo)<br>(Nellcor) | Averaging time:4,6,8,10,12,14,16sec. Sensitivity setting:APOD, Normal, Max FastSat:ON, OFF<br>SatSeconds:10,25,50,100, OFF Response:Normal, Fast |

### Resuscitation Unit 104

|                                     |  |
|-------------------------------------|--|
| General                             | Pressure indication: -2~8kPa (-20~80cmH <sub>2</sub> O)  |
| Suction unit                        | Suction pressure control range:0~26.7kPa (0~200mmHg)   |
| Oxygen blender /<br>flow meter unit | Oxygen concentration range:21~100%<br>Flow rate range:0~15L/min  |
| Resusci Flow unit                   | Maximum pressure limit (PMAX) setting range:2.0~5.9kPa (20~60cmH <sub>2</sub> O)<br>Default setting:3.9kPa (40cmH <sub>2</sub> O)  |
| Accessories                         | Patient Circuit ..... 1 Test Bag, 50mL ..... 1 Piping Connecting Hose for Air ..... 1<br>Piping Connecting Hose for Oxygen ... 1 Outlet Connecting Hose for Air/Oxygen ... 1 Oxygen Supply Hose ..... 1<br>Face Mask for Neonatal ..... 1 Face Mask for Infant ..... 1 Oxygen Humidifier Jar Holder ..... 1<br>Humidifier Bottle OX-230 ..... 1 Outlet Connecting Hose for Suction ..... 1 Piping Connecting Hose for Suction ... 1<br>Suction Jar Holder ..... 1 Suction Canister, 500mL ..... 1 Dispo Liner, 500mL ..... 1<br>Suction Hose ..... 1 Silencer (for E-type)..... 1 Operation Manual ..... 1 |

### Blender Unit 105

|                                     |  |
|-------------------------------------|--|
| General                             | Pressure indication: -2~8kPa (-20~80cmH <sub>2</sub> O)  |
| Suction unit                        | Suction pressure control range:0~26.7kPa (0~200mmHg)   |
| Oxygen blender /<br>flow meter unit | Oxygen concentration range:21~100%<br>Flow rate range:0~15L/min  |
| Accessories                         | Piping Connecting Hose for Air ... 1 Piping Connecting Hose for Oxygen ... 1 Outlet Connecting Hose for Air / Oxygen ... 1<br>Oxygen Supply Hose ..... 1 Tube for Pressure Measurement ..... 1 Oxygen Humidifier Jar Holder ..... 1<br>Humidifier Bottle OX-230 ..... 1 Outlet Connecting Hose for Suction ... 1 Piping Connecting Hose for Suction ..... 1<br>Suction Jar Holder ..... 1 Suction Canister, 500mL ..... 1 Dispo Liner, 500mL ..... 1<br>Suction Hose ..... 1 Silencer (for E-type)..... 1 Operation Manual ..... 1 |

### Weight Monitor

|                |   |
|----------------|---|
| Weighing range | 7000g   |
| Scale interval | 1g (weight monitor without official verification)<br>5g (weight monitor with official verification) |



Atom Medical products are produced under strict production control in Japan.  
We provide value and trust of the highest quality for the tiny baby lives in the world.

#### Manufacturer:

18-15, Hongo 3-chome, Bunkyo-ku, Tokyo, 113-0033 JAPAN  
<http://www.atomed.co.jp>

#### Exporter: ATOM MEDICAL INTERNATIONAL, INC.

SWT Bldg., 15-9 Hongo 3-chome, Bunkyo-ku, Tokyo, 113-0033 JAPAN  
Phone: + 81 3 3815 2941 Fax: + 81 3 3812 9670/4080